

“CHIPMASTER” Fresas de alto rendimento

Fresa "Chipmaster" para rasgo em "T" DIN 650, haste paralela, corte à direita.

"Chipmaster" "T" slot milling cutter DIN 650, straight shank, right hand cut.

HÉLICE
25°

M42
Co 8

DIN
851
AA NF



1605



d1 d11 mm	b d11 mm	L mm	d2 h8 mm	Z	Rasgo inicial DIN 650
16	8	62	10	6	8
18	8	70	12	6	10
19	9	71	12	6	10
21	9	74	12	6	12
22	10	75	12	6	12
25	11	82	16	8	14
28	12	85	16	8	16
32	14	90	16	8	18
36	16	103	25	8	20
40	18	108	25	8	22
45	20	113	25	8	24

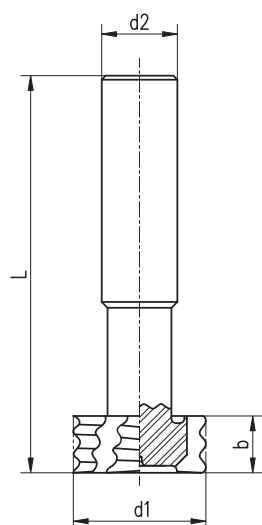
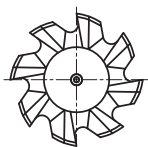

1ª Operação

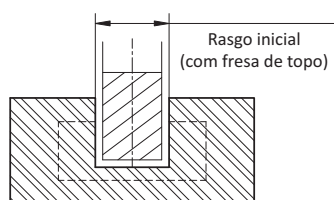

2ª Operação

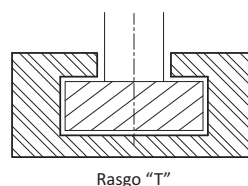

Perfil NF
Semi acabamento