

**Fresa para rasgo de chaveta WOODRUFF, haste cilíndrica, corte à direita, dente reto.**  
 WOODRUFF drive slot cutter, straight shank, right hand cut, straight tooth.

DENTE RETO
M2
DIN 850 AH

**1642**

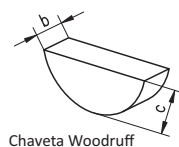
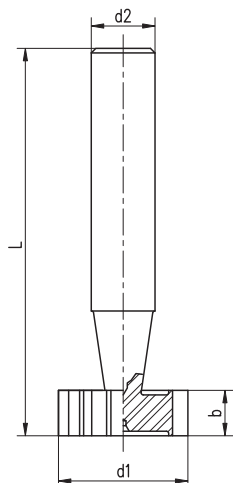
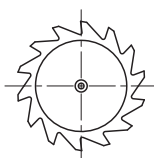

d1	b	L	d2	Z	Especif. da chaveta (b x c)
h11 mm	e8 mm	mm	h8 mm		mm
10,5	2	50	6	10	2 x 3,7
10,5	2,5	50	6	10	2,5 x 3,7
10,5	3	50	6	10	3 x 3,7
13,5	2	56	10	10	2 x 5
13,5	3	56	10	10	3 x 5
13,5	4	56	10	10	4 x 5
16,5	3	56	10	10	3 x 6,5
16,5	4	56	10	10	4 x 6,5
16,5	5	56	10	10	5 x 6,5
19,5	3	63	10	12	3 x 7,5
19,5	4	63	10	12	4 x 7,5
19,5	5	63	10	12	5 x 7,5
19,5	6	63	10	12	6 x 7,5
22,5	3	63	10	12	3 x 9
22,5	4	63	10	12	4 x 9
22,5	5	63	10	12	5 x 9
22,5	6	63	10	12	6 x 9
22,5	7	63	10	12	7 x 9
22,5	8	63	10	12	8 x 9
25,5	4	63	10	14	4 x 10
25,5	5	63	10	14	5 x 10
25,5	6	63	10	14	6 x 10
25,5	7	63	10	14	7 x 10
28,5	6	63	10	16	6 x 11
28,5	7	63	10	16	7 x 11
28,5	8	63	10	16	8 x 11
28,5	10	71	12	16	10 x 11
32,5	6	71	12	18	6 x 13
32,5	7	71	12	18	7 x 13
32,5	8	71	12	18	8 x 13
32,5	10	71	12	18	10 x 13
38,5	6	71	12	20	6 x 15
38,5	8	71	12	20	8 x 15
45,5	10	71	12	32	10 x 16

d1	b	L	d2	Z
h11 pol	e8 pol	pol	h8 pol	
1/2	3/32	2	3/8	10
1/2	1/8	2	3/8	10
5/8	3/32	2 1/4	3/8	10
5/8	1/8	2 1/4	3/8	10
5/8	5/32	2 1/4	3/8	10
3/4	1/8	2 1/2	1/2	12
3/4	5/32	2 1/2	1/2	12
3/4	3/16	2 1/2	1/2	12
3/4	1/4	2 1/2	1/2	12
7/8	5/32	2 1/2	1/2	12
7/8	3/16	2 1/2	1/2	12
7/8	7/32	2 1/2	1/2	12
7/8	1/4	2 1/2	1/2	12
1	3/16	2 1/2	1/2	14
1	7/32	2 1/2	1/2	14
1	1/4	2 1/2	1/2	14
1	5/16	2 1/2	1/2	14
1 1/8	3/16	2 1/2	1/2	16
1 1/8	7/32	2 1/2	1/2	16
1 1/8	1/4	2 1/2	1/2	16
1 1/8	5/16	2 1/2	1/2	16
1 1/4	3/16	2 13/16	1/2	18
1 1/4	7/32	2 13/16	1/2	18
1 1/4	1/4	2 13/16	1/2	18
1 1/4	5/16	2 13/16	1/2	18
1 1/4	3/8	2 13/16	1/2	18
1 3/8	1/4	2 13/16	1/2	18
1 3/8	5/16	2 13/16	1/2	18
1 3/8	3/8	2 13/16	1/2	18
1 1/2	1/4	2 13/16	1/2	20
1 1/2	5/16	2 13/16	1/2	20
1 1/2	3/8	2 13/16	1/2	20

A fresa pode ser definida pela especificação da chaveta ou pelo  $\phi d1$  e espessura b